



****AVAILABLE IMMEDIATELY****

****UNFURNISHED** **OFF STREET**

PARKING** Situated in the prestigious location of Jesmond Park West, this two bedroom apartment is found on the ground floor of the High Dene development. This smart property boasts a pleasant outlook, off street parking and is ideal for a professional couple or single occupant.

The property briefly comprises a communal entrance hallway with stairs to all floors. The apartment itself has two double bedrooms, both with fitted wardrobe space; a spacious lounge with dual aspect outlook; a modern fitted kitchen with appliances; there is also a family bathroom WC with storage cupboard. Externally there are well kept communal gardens, one allocated off street parking space as well as off street bays for residents parking.

Well presented and available on an unfurnished basis, this is a great apartment is ideal for either a couple or single occupant.

Available Immediately | £850pcm | Unfurnished
| Ground Floor Apartment | 468 Sq ft (43.5 m²)
| Lounge | Modern Kitchen | Two Bedrooms |
Bathroom WC | Communal Gardens | Great
Location | Off Street Allocated Parking | DG &
GCH | Council Tax Band: C | EPC Rating: C



GROUND FLOOR
468 sq.ft. (43.5 sq.m.) approx.

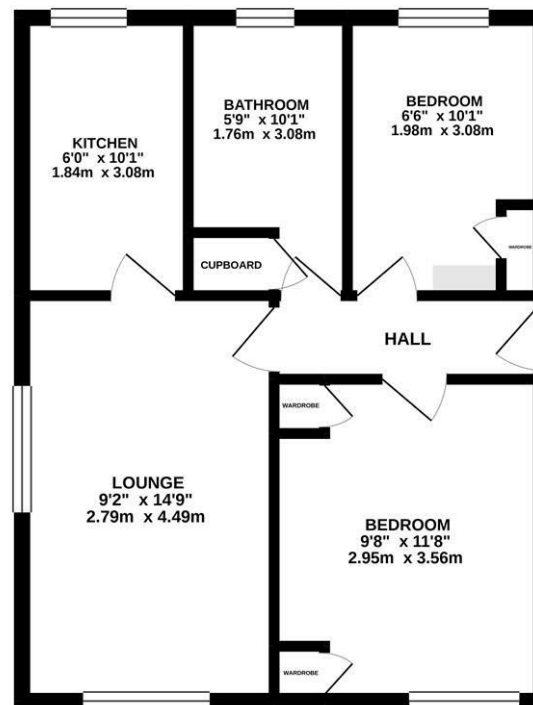

£850 PCM

IMPORTANT NOTE: These particulars and the descriptions and measurements herein do not constitute representation and whilst every effort has been made to ensure accuracy, this cannot be guaranteed.

TOTAL FLOOR AREA : 468 sq.ft. (43.5 sq.m.) approx.
Whilst every attempt has been made to ensure the accuracy of the floorplan contained herein, measurements of doors, windows, rooms and any other items are approximate and no responsibility is taken for any error, omission or misstatement. This plan is for illustrative purposes only and should be used as such by any prospective purchaser. The services, systems and appliances shown have not been tested and no guarantee as to their operability or efficiency can be given.
Made with Mirogo 1/2021

